



# Retail, Office or Medical Office Space For Lease

1449 SW Gatlin Boulevard, Port St. Lucie, FL 34953



## PROPERTY STATS:

Building Space: 17,900 +/- GSF  
Bay Depth: 60—70 ft +/-  
Bay Width: 20—30 ft +/-  
Land: 1.92 +/- Acres  
Parking: 89 Spaces

**DESCRIPTION:** This new center is a 17,900 SF +/- retail, office and medical office building in the heart of Port St. Lucie. Space can be configured to meet your needs.

## AVAILABLE UNITS:

**Unit 7:** 1,184 SF +/- (shell condition)  
\$36.00 NNN—\$8.00 psf

**Unit 9:** 1,077 SF +/- (shell condition)  
\$36.00 NNN—\$8.00 psf

**Unit 12:** 2,471 SF +/- (partially built out)  
\$44.00 NNN—\$8.00 psf

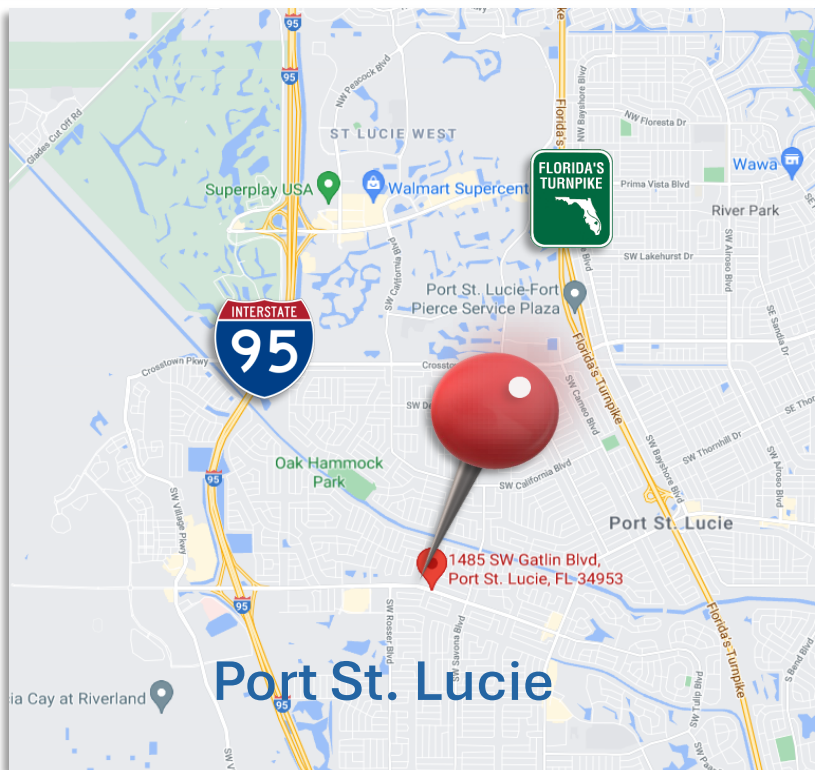

CALL  
US

NATE BRAY  
ADEMIL CASTRILLO  
(561) 510-2225



## FLOOR PLAN

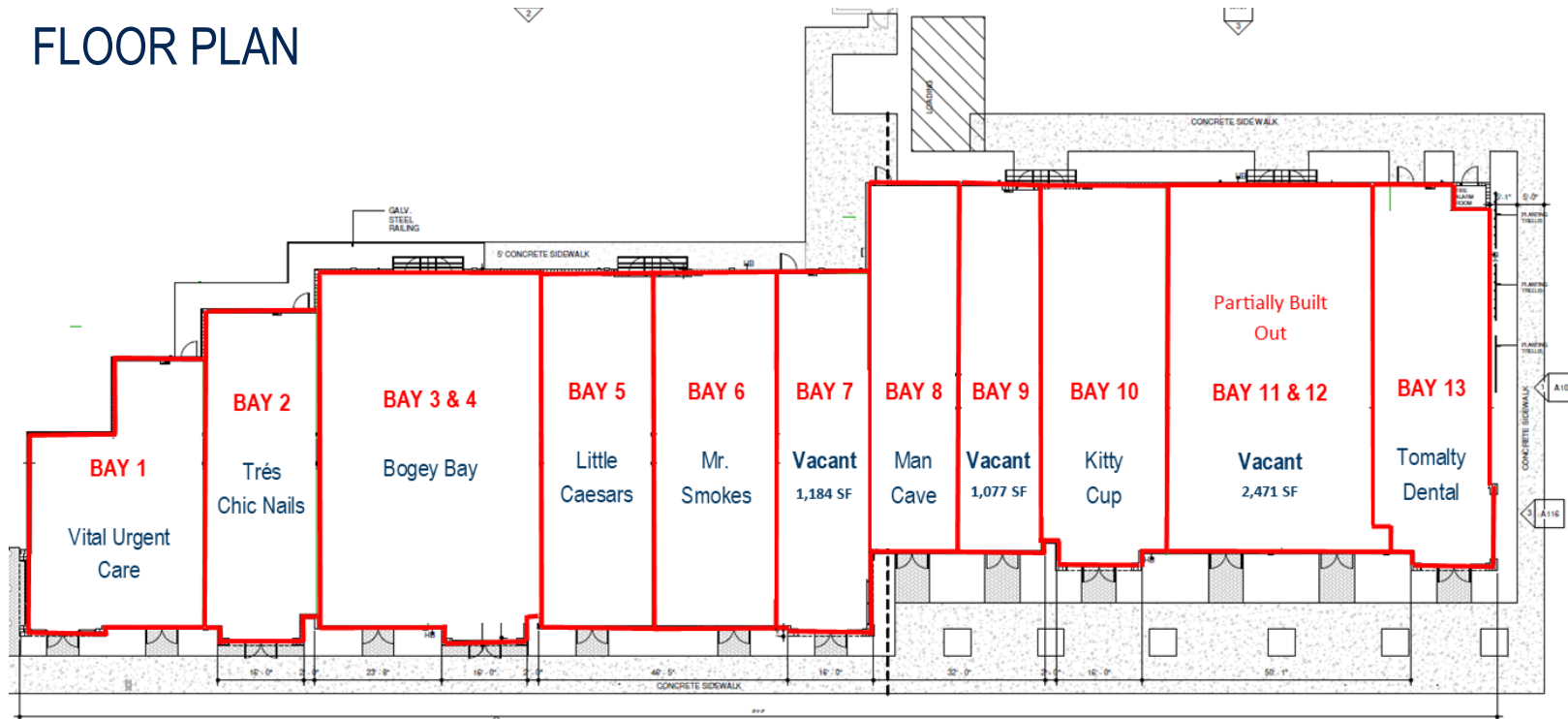

## AERIAL VIEW

