

10753 S US Highway 1, Port St. Lucie, FL



ESTIMATED COMPLETION 2nd Qtr. 2026

DESCRIPTION:

- New retail building/7,900 +/- SF
- Includes drive-thru
- Can be divided into 4 bays (80 ft deep, 25-35 ft wide)
- 5.47 +/- Acres
- Zoning: General Commercial, St. Lucie County
- High Traffic Location on US Highway 1
- Adjacent to Walmart Supercenter
- Cross Access with Walmart
- High Traffic Counts 50,500 ADT
- Approximately 453.65' of frontage on US Hwy 1

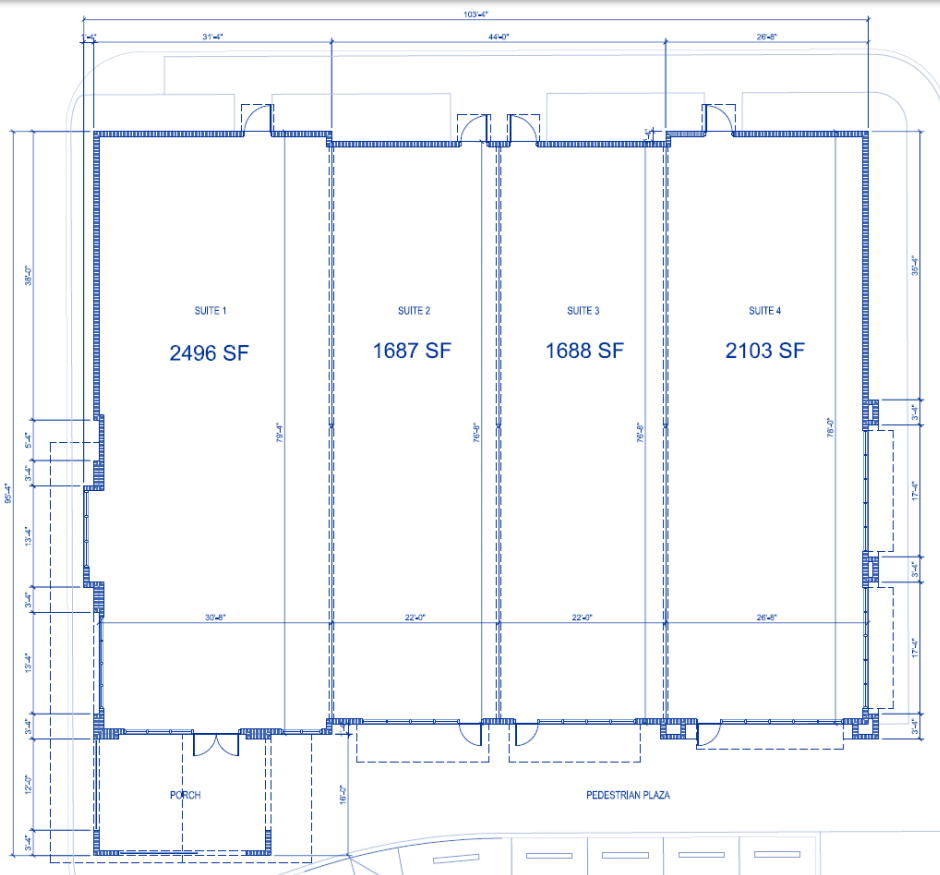

CALL US

**NATE BRAY
JOHN DELRUSSO
(561) 510-2225**

10753 S US Highway 1, Port St. Lucie, FL

